

**New**  
Automatic hood, GiO-Module,  
AirBox AktivAir exhaust air treatment



## Premium class dishwashers



## Double-basket pass-through dishwashers

**DV 200.2**

**DV 200.2 PW PowerWash**



## DV 200.2 and DV 200.2 PW: double-basket pass-through dishwashers with perfect technology for efficient, in-line operation

Excellent output per hour, fully electronic controls, excellent cleaning results, space-saving compact construction and low operating costs: these are the outstanding advantages of the new, re-designed DV 200.2 and DV 200.2 PW pass-through dishwashers. They are genuine industrial washing machines for even the most demanding tasks,

and are equipped with the latest dishwashing technology. A user-oriented range of accessories also ensures an effective solution to every problem.

The perfect design of these two machines closes the gap between our single-basket pass-through dishwashers and our higher-output basket conveyor models.

**DV 200.2 and DV 200.2 PW:**  
Cleaning two baskets at the same time and during the same programme cycle provides double output. Alternatively, they can be used for large items which will not fit into a single basket.



The DV 200.2  
pass-through  
dishwasher

### MEIKO DV 200.2 PW

**The power-wash appliance with the suitable pressure level:**

The DV 200.2 PW is not only executed with **three different programme cycles but also three different pressure levels. Means: Three different models but only one machine for either gentle, intensive or power programme.**

**A special MEIKO highlight: the multi-purpose model DV 200.2 PW dishwasher. Now you can always use the suitable pressure level.**

### Your advantages:

- Three different control modes depending on items to be washed and degree of soiling
- Short programme e.g. for coffee cups
- Normal programme for dishes
- Intensive programme for kitchen equipment, pots etc.
- Exact pump capacity to suit the task - reducing your energy costs.



The DV 200.2 PW pass-through dishwasher with automatic hood (option)



DV 200.2 PW pass-through machine with **AirBox AktivAir** exhaust treatment (option)

### New in the Premium Class: the DV 200.2 with automatic hood (option)

- Separate button for opening and closing the hood
- Increased capacity utilisation
- No manual hood actuation necessary
- Continuous loading
- Outstanding ergonomics



### AirBox **AktivAir** exhaust treatment (option):

#### Convenience in the wash-up area

- Central exhaust treatment
- Significant reduction of exhaust nuisance
- No exhaust nuisance of the wash-up personnel
- Integrated condensate drain
- Controlled start-up of extraction via cleaning programme
- Time-controlled delay of the fan
- No filter and maintenance free
- Can be retrofitted



## Fully electronic control: Infrared technology guarantees frist-class service

### Progressive comfortable operation : The electronic control

The MEIKO DV 200.2 and DV 200.2 PW pass-through dishwashers are equipped with a fully electronic MIKE 2 control. The three programmes are selected by gently touching the appropriate field of the sensor touch panel. The programme status and any messages are shown on a digital display. Easily understood symbols and a clear wash and rinse temperature display make operation and control of these appliances child's play.



### MIKE 2 - the brand-new elec- tronic control system with an integral infrared interface for the "Point Two" generation of appliances.

Today's most innovative control technology for dishwashers. Using the intelligent "M-Commander W" (for a palm-PDA), data can be read, defined, amended or, with a PC, even quickly transferred to the MEIKO factory or your local Customer Service Depot so that work can start on the data right away - a process which offers the customer clear advantages in terms of work, time and money during maintenance operations.



## Reverse osmosis system: Brilliant water treatment performance

### GiO-Module (option)

The reverse osmosis system for a first-class water treatment

- most compact dimension
- with complete connection kit
- fully integrated in the control system of the dishwashing machine

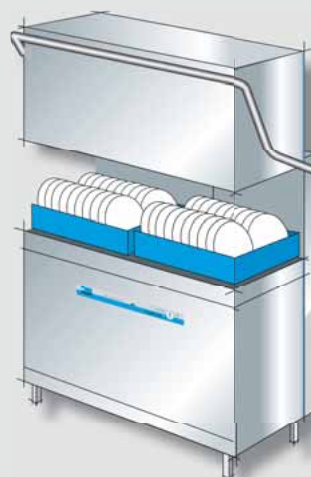

## Performance and economy under the hood

- **Double-walled insulation** of the hood

- Upper and lower **stainless steel washing and rinsing system**

- **Sloping top** with circumferential water channel prevents those annoying drops from falling onto freshly-washed dishes

- **Smooth, easy-to-clean interior walls**

- **"Aktiv-Plus" wash-water filter system**  
Sparkling cleaning result due to multiple filtration of the wash water

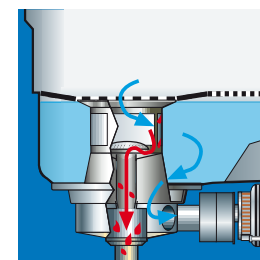

- **Self-cleaning programme** for automatic cleanliness



**Premium washing results with only - 5.2 liters of water per wash cycle**

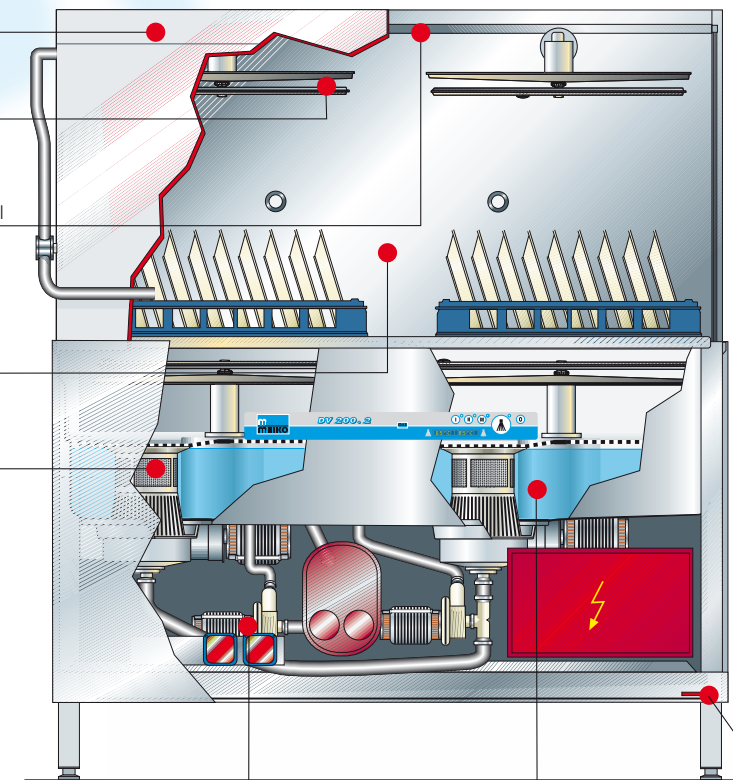

- **Booster pump** providing a final rinse result independent from the mains pressure - constant rinse temperature and water volume.

- **Deep-drawn wash tank** at the front of the appliance enables easy maintenance.

- Option DV 200.2: **ADT-detergent dosing technology** safe - reliable - long-lasting



- **Aqua-Stop system with bottom pan** Exceptionally high operation safety with automatic leak water control and protection of all installed components.

- **Installation by means of a connection kit (water, waste water and electric power)** Rapid and low-cost commissioning, incorporated drain pump. Drain pipe can be located up to 700 mm above floor level.

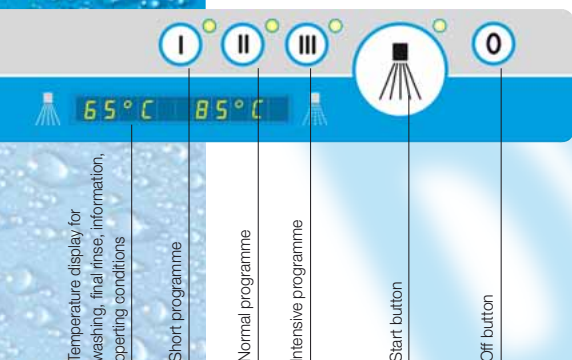

Temperature display for washing, final rinse, information, operating conditions

Short programme

Normal programme

Intensive programme

Start button

Off button



## Functional details - Made by professionals for professionals



◀ **440 mm entry height**  
which means no problems with euro-trays, tall dishes or beer glasses.

▶ **Easy operation with the all-around handle.**  
Pressing the handle starts the programme. (Automatic hood start).



◀ **Perfect view all over the complete wash chamber.**  
Well-designed, easily removable sieves cover the wash tank below.

◀ **Powerful tank heating incorporated in the tank.**  
100% utilization of the heat - no radiation losses. Constant tank temperatures during operation, highest hygiene safety.



◀ **The "AktivPlus" wash-water filter system.**  
It works in conjunction with the tank screens to ensure long-lasting optimal filtration of the wash-water and superb, hygienic cleaning quality.

### Further standard features:

- Rinse aid dosing unit
- 150 mm floor clearance
- The rear opening of the hood avoids vapor being led towards the operator

- Temperature depending extension of the washing cycle. Hygiene safety during operating.
- Tank volume 54 liters, quickly ready for operation, low operating costs, rapid tank cleaning.
- Stainless steel switch cabinet
- Customer-friendly service: Ideal accessibility, clear installation, excellent reliability (Type IP X5 protection), rapid and reliable MEIKO after sales service network.
- Quality tested and awarded a range of test certificates.

### Brand-new, innovative and user-friendly - water changing programme (option)

The water in the tank can be changed with one touch of a button, so that you can clean with fresh water immediately. Fully automatic and uncomplicated - for hygienic and sparkling cleaning results.

## Effective designs = Client focused planning proposals

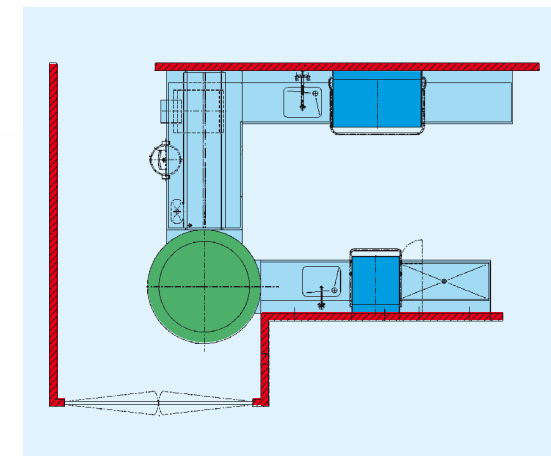
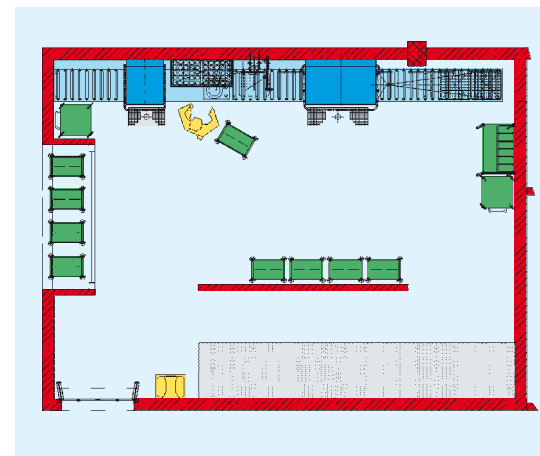
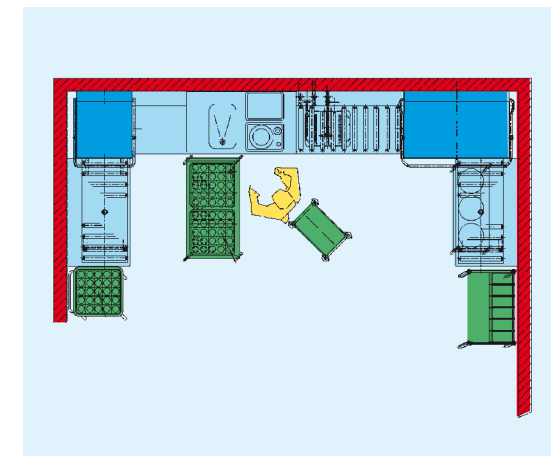
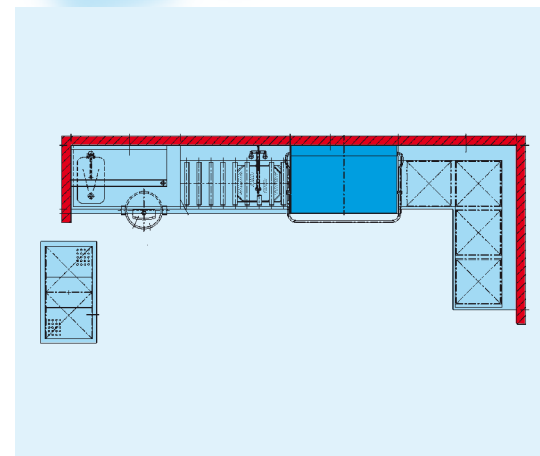

### Individual installations possible

Whether for straight line operation or as space-saving corner model, the ingenious construction of MEIKO pass-through dishwashers allows an almost unlimited range of layouts.

### For all types of professional use, whether in

- gourmet restaurants
  - self-service and fast-food restaurants
  - hotels
  - company, school and university canteens
  - old age homes
- we can provide the most efficient dish-washing solution for you from our extensive production range.

Our wide-ranging planning experience and know-how enable us to provide efficient and economic designs for every washing-up area. Please contact us if you would like to get an individual proposal.



# Dimensions and technical data

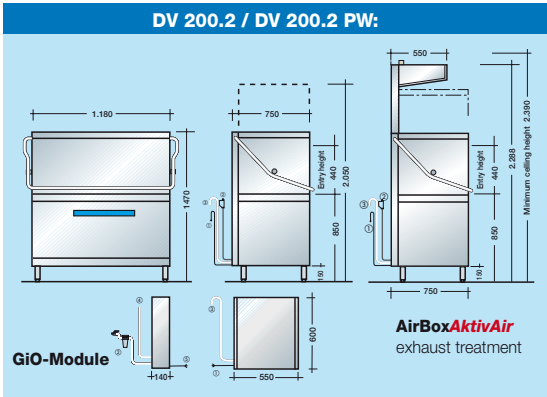

### Programme cycles available for selection:

- DV 200.2:**
- Short programme = 60 seconds
  - Normal programme = 90 seconds
  - Intensive programme = 210 seconds
- DV 200.2 PW:**
- Gentle programme = 60 seconds (pressure level I)
  - Intensive programme = 90 seconds (pressure level II)
  - Power programme = 210 seconds (pressure level III)

If the appliance is connected to cold water supply and / or if baskets are changed frequently the programme cycles may increase to achieve a hygienic final rinse temperature.  
The programme cycles increase within the water changing programme.



**MEIKO recommends branded cleaning products of well-known manufacturers.**

**MEIKO LOW** cleaning and hygiene products are an excellent choice.



**MEIKO Maschinenbau GmbH & Co. KG**  
Englerstr. 3 · 77652 Offenburg · Germany  
Tel. (+49) 781/203-0 · Fax (+49) 781/203-1121  
www.meiko.de · E-Mail: info@meiko.de

	DV 200.2	DV 200.2 PW
Basket dimensions / mm	500 x 500	500 x 500
Entry height / mm	440	440
Theoretical basket capacity / hour	120/80/34	120/80/34
Pump motor kW	2 x 0,75	2 x 1,5
Tank volume liters	54	54
Final rinse liters	5,2	5,2
Tank heating kW	4,0	4,0
Incorporated boiler at		
45°C supply temperature kW	12,0	12,0
10°C supply temperature kW	18,0	18,0
Elektr. Gesamtanschluss bei		
45°C supply temperature kW	13,9	15,4
10°C supply temperature kW	19,9	21,4

### Electrical installation:

Electrical connection: ① 3-phase current 3 NPE, 400 V, 50 Hz.  
*AirBox AktivAir* (option) increases the connection value about 0,9 kW.  
The wiring complies with VDE requirements.

### Water installation:

The machines may be connected directly to the mains supply without intermediate security fittings ②. The flow pressure should be between 0,6 bar and 5 bar. The installation requirements of EN 1717 must be observed.  
Drain 3/4". Wall-mounted drain should have a maximum height of 700 mm ③.  
Length of connection cables from/to the appliance approx. 1,8 m.

### GiO-Module:

With thermostatic water mixer. Cold and warm water supply is necessary.  
Cold water min. 1 °C – max. 35 °C, warm water max. 60 °C. Flow pressure should be between 1 and 5 bar. Conductivity of raw water <1000 µS/cm. Total water hardness max. 28 °dH (German hardness). Including connection kit: check valve, pressure regulating valve, filter 10 µm including activated carbon, safety equipment "HD" (backflow preventer and pipe aerator). Installation requirements of EN 1717 must be observed. Connection length approx. 3 m. Connection kit of the appliance with reinforced hose (without AquaStop). Concentrate drain 1/2" ④, length approx. 2 m. Permeate and electric cables between machine and separate GiO-Module approx. 3,0 m ⑤.

(1 bar = 100 kPa) (1 °dH ca. 0,18 mmol/l CaCO<sub>3</sub>)



Complies with the hygiene requirements of DIN 10512 for commercial dishwashing and DIN 10522 for commercial washing of containers and boxes

